

XW4A/B 连接器端子台 (端子间距3.81mm)

外形尺寸

(单位: mm)

电线侧端子台
(插座)
XW4B-□□B1-H1

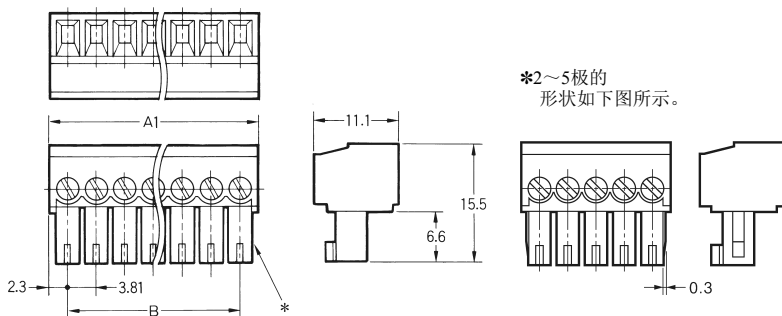
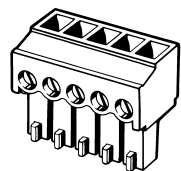

尺寸表

尺寸 (mm) 极数	A1	A2	B
2	8.4	9.0	3.81
3	12.2	12.8	7.62
4	16.0	16.6	11.43
5	19.8	20.4	15.24
6	23.7	24.3	19.05
7	27.5	28.1	22.86
8	31.3	31.9	26.67
9	35.1	35.7	30.48
10	38.9	39.5	34.29

基板侧端子台
(插头、L型端子)
XW4A-□□B1-H1

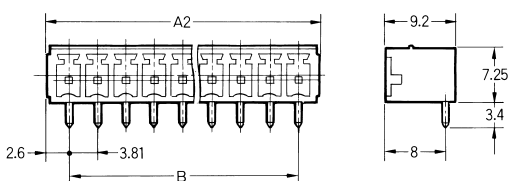
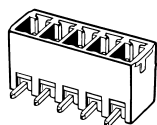

印刷基板加工尺寸
(BOTTOM VIEW)

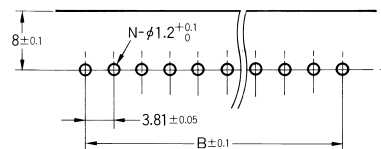

基板侧端子台
(插头、直型端子)
XW4A-□□B1-V1

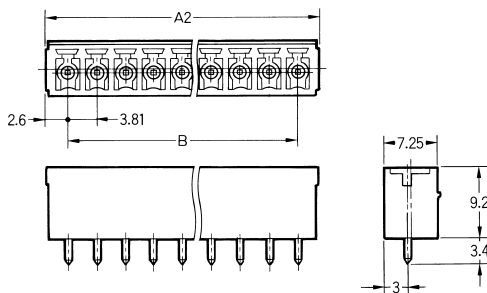
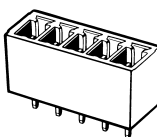

印刷基板加工尺寸
(BOTTOM VIEW)

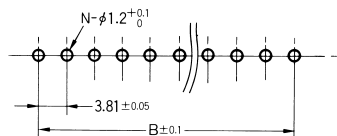

嵌合图

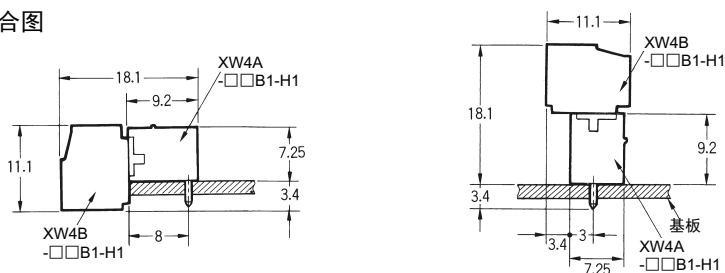

种类

极数	形状	电线侧端子台 (插座)		基板侧端子台 (插头、L型端子)		基板侧端子台 (插头、直型端子)	
		型号	最小包装单位 (个)	型号	最小包装单位 (个)	型号	最小包装单位 (个)
2		XW4B-02B1-H1	50	XW4A-02B1-H1	100	XW4A-02B1-V1	100
3		XW4B-03B1-H1		XW4A-03B1-H1		XW4A-03B1-V1	
4		XW4B-04B1-H1		XW4A-04B1-H1		XW4A-04B1-V1	
5		XW4B-05B1-H1		XW4A-05B1-H1		XW4A-05B1-V1	
6		XW4B-06B1-H1		XW4A-06B1-H1		XW4A-06B1-V1	
7		XW4B-07B1-H1		XW4A-07B1-H1		XW4A-07B1-V1	
8		XW4B-08B1-H1		XW4A-08B1-H1		XW4A-08B1-V1	
9		XW4B-09B1-H1		XW4A-09B1-H1		XW4A-09B1-V1	
10		XW4B-10B1-H1		XW4A-10B1-H1		XW4A-10B1-V1	

XW4A/B 连接器端子台 (端子间距5.08mm)

外形尺寸

(单位: mm)

电线侧端子台
(插座)
XW4B-□□C1-H1

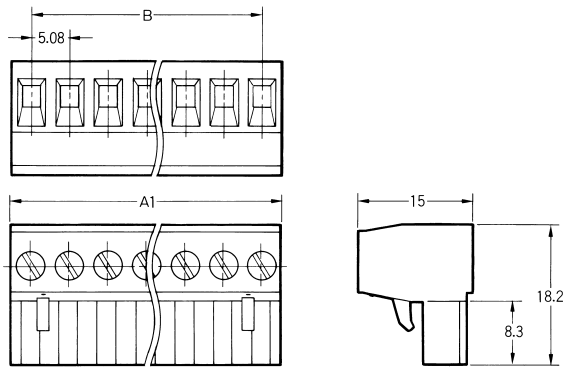
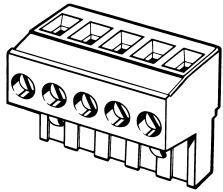

尺寸表

尺寸 (mm) 极数	A1	A2	B
2	10.1	12.2	5.08
3	15.2	17.2	10.16
4	20.3	22.3	15.24
5	25.4	27.4	20.32
6	30.5	32.5	25.40
7	35.6	37.6	30.48
8	40.6	42.6	35.56
9	45.7	47.7	40.64
10	50.8	52.8	45.72

基板侧端子台
(插头、L型端子)
XW4A-□□C1-H1

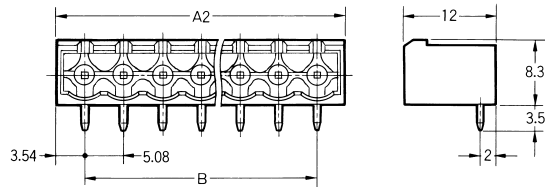
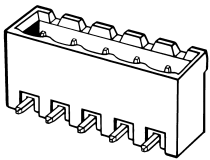

印刷基板加工尺寸
(BOTTOM VIEW)

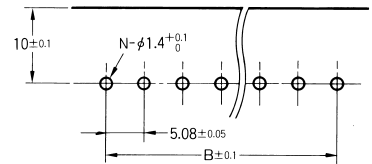

基板侧端子台
(插头、直型端子)
XW4A-□□C1-V1

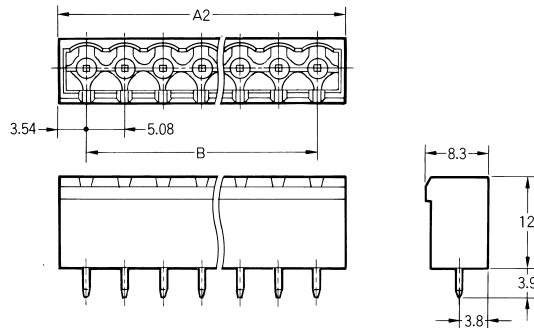
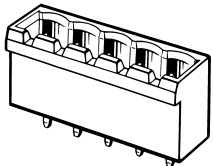

印刷基板加工尺寸
(BOTTOM VIEW)

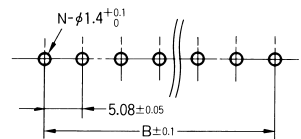

嵌合图

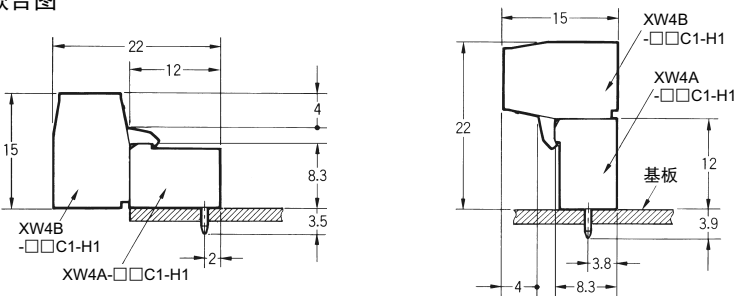

■种类

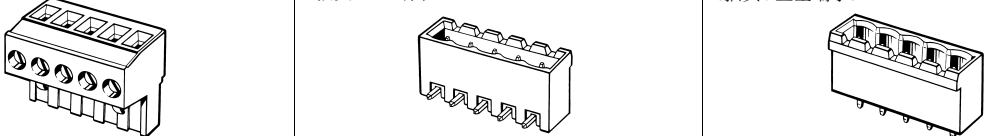
形状	电线侧端子台 (插座)		基板侧端子台 (插头、L型端子)		基板侧端子台 (插头、直型端子)		
	极数	型号	最小包装单位(个)	型号	最小包装单位(个)	型号	最小包装单位(个)
	2	XW4B-02C1-H1	50	XW4A-02C1-H1	100	XW4A-02C1-V1	100
	3	XW4B-03C1-H1		XW4A-03C1-H1		XW4A-03C1-V1	
	4	XW4B-04C1-H1		XW4A-04C1-H1		XW4A-04C1-V1	
	5	XW4B-05C1-H1		XW4A-05C1-H1		XW4A-05C1-V1	
	6	XW4B-06C1-H1		XW4A-06C1-H1		XW4A-06C1-V1	
	7	XW4B-07C1-H1	XW4A-07C1-H1	XW4A-07C1-V1	50	XW4A-08C1-V1	50
	8	XW4B-08C1-H1	XW4A-08C1-H1	XW4A-08C1-V1			
	9	XW4B-09C1-H1	XW4A-09C1-H1	XW4A-09C1-V1			
	10	XW4B-10C1-H1	XW4A-10C1-H1	XW4A-10C1-V1			

■附件

插入电桥 (端子间距5.08mm用)

XW4Z-□□C

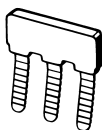

极数	最大电流	型号	最小包装单位(个)
2	12A	XW4Z-02C	100
3	12A	XW4Z-03C	

螺丝刀

XW4Z-00B

XW4Z-00C

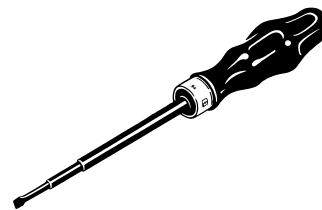

型号	适用端子台	最小包装单位(个)
XW4Z-00B	端子间距5.0mm、3.81mm、3.5mm	10
XW4Z-00C	端子间距5.08mm、5.0mm	